

www.nwaperio.com

nwaperio@aol.com

PERIODONTAL CONSULTATION REFERRAL

Referred by: _____

Introducing: _____ Tel. #: _____

Appointment date: _____ Time: _____

Do they need Pre-Med? Yes No

Periodontal therapy in your office to date: _____

I am sending: Full mouth survey Panoramic radiograph
 Bite wings No current radiographs available

Comments: _____

- Periodontal Disease
 - Full Exam
 - Isolated teeth (indicate on charge below)
- Bone Regeneration - Ridge Augmentation
- Crown Lengthening (Anterior for Esthetics)
- Crown Lengthening (Posterior for Function)
- Esthetic Gingival Contouring
- Dental Implant
- Biopsy
- Orthodontic Tooth Exposure
- Frenectomy
- Soft Tissue Graft
- Other _____

AREAS OF CONCERN:

1	2	3	4	5	6	7	8	9	10	11	12	13	14	15	16
32	31	30	29	28	27	26	25	24	23	22	21	20	19	18	17

The restorative treatment plan may include:

- Operative
- Crown and Bridge
- Implants
- Occlusal Therapy
- Partial Dentures
- Maxillary Mandibular
- Dentures
- Maxillary Mandibular

Comments: _____

Thank you for entrusting us with the care of your patient!

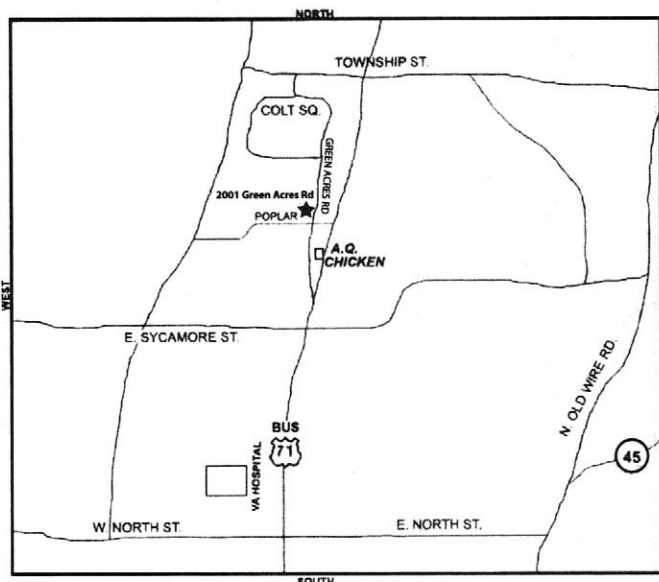

FAYETTEVILLE OFFICE:

201 Green Acres Road, Fayetteville, Arkansas 72703
phone: 479-521-6400 • fax: 479-521-0164



ROGERS OFFICE:

300 S. Metro Parkway, Rogers, Arkansas 72758
phone: 479-636-8800 • fax: 479-636-8801